

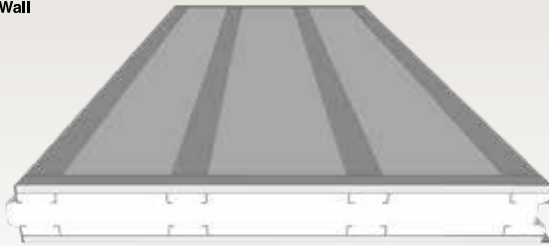

xPANEL
Exterior Wall



xPanel - 48" max width x 144" max height. Single and compound angles according to architectural details.

5.5" and 7.5" Thickness
R-35 to R-50 (Effective)
4-in-1, Structure, Insulation, Sheathing, Vapor Barrier
Load bearing
Up to 8 stories with no additional structure
Density 1.0-1.5pcf
Arrives on site with door and window openings

iPANEL
Interior Wall



iPanel - 48" max width x 144" max height. Single and compound angles according to architectural details.

3.5" Thickness
Up to R-23
Load Bearing
Arrives on site with door and window openings
Used as load bearing, demising walls

rPANEL
Roof Panel

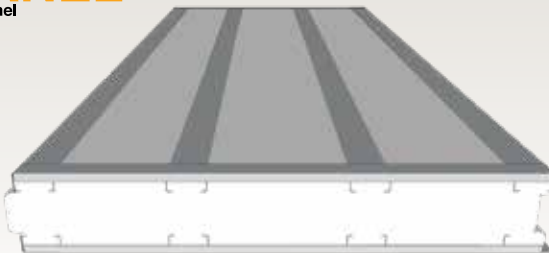

rPanel - 48" max width x 144" max length. Single and compound angles according to architectural details. Reduces truss from spacing from 2' on center up to 10'.

5.5" and 7.5" Thickness
R-35 to R-50 (Effective)
Up to 220mph wind load
EPS density 1.0-1.5psf

fPANEL
Floor Panel



fPanel - 48" Max width, 144" max length. Panels connect end-to-end and side-to-side for coverage. Rebar troughs to form grade beams, top with rebar mesh and 3-4" concrete. Panels connect end to end and side to side for coverage.

Free spans up to 42ft.
Reduces floor weight up to 40%



CloudHauz™ Panelized Structures:

Optimize Your Building Opportunities

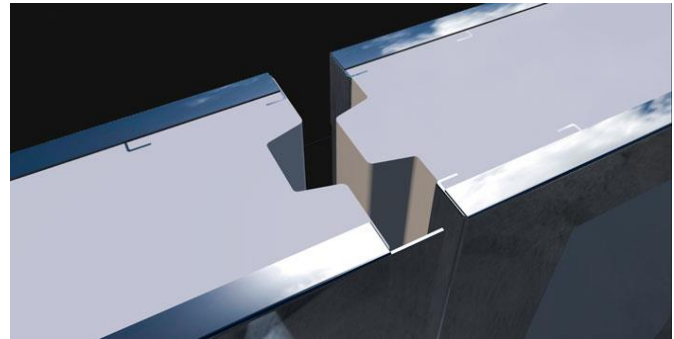

- ✓ **4-in-1 Panels:** Lock together in just minutes using a power screwdriver to provide the 1. “load-bearing” framing 2. thermal insulation 3. sheathing and 4. vapor barrier that make up the “core structure” or “bones” of each CloudHauz™ dwelling, achieving the highest levels of building optimization.
- ✓ **50% Time Savings:** Cut your wall, floor and roof construction time by 50%.
- ✓ **Increased Productivity and Precision:** All wall, floor and roof panels are manufactured in a quality-controlled environment to precise standards and delivered with door and window openings cut and ready for installation. Precision manufacturing means walls, roof and floors provide improved quality which reduces “call backs” to correct the imperfections of stick builds.
- ✓ **Fewer Skilled Workers Required:** The panels lock together tongue and groove style and are screwed together.
- ✓ **Predictable Budgets and Timelines:** Decreases the time and budget variables associated with traditional builds.
- ✓ **No Weather Delays:** Because much of the work is done inside a factory, onsite weather delays and damage caused by weather is greatly reduced.
- ✓ **Less Waste:** Onsite waste is reduced by as much as 75%. You will have a cleaner, more organized jobsite and save money with fewer trips to the lumber yard, fewer products to purchase, fewer steps in the building process and fewer trips to landfill.



We Check All The Right Boxes

- ✓ **Fire Resistant:** Our patented, customized panels meet one, two- and three-hour requirements.
- ✓ **Hurricane-Resistant:** Designed for up to 250 mph wind loads.
- ✓ **Earthquake-Resistant:** Seismic resistance up to a 9.0 on Richter
- ✓ **Insect, Mold, Rodent-Deterrent:** Our closed cell structural envelope with airtight-fitting inter-locking panels leave no gaps for entry of the dwelling by vermin (mice, rats, spiders, cockroaches

and more) or wood boring pest like termites since there is not food source within the panels. There is no moisture absorption by the closed cell structure, thus mold, dry rot and fungus don't occur.

- ✓ **Reduces Noise Pollution:** Assemblies up to 60 STC, improves sound attenuation
- ✓ **Energy Efficient/Cuts Energy Costs by 75%:** Eliminates thermal bridging and air filtrations, delivering up to R-47
- ✓ **Environmentally Friendly and Net Zero Building:** Made from 100% recycled materials in an automated, just-in-time manufacturing facility optimizing the construction building lifecycle to help us reach Net Zero.
- ✓ **Toxic Free:** Does not off gas. EPS, CFC and HCFC free. No carcinogens, allergens, or pathogens.
- ✓ **Limited Life-Time Warranty:** Our panels are warrantied for a lifetime, provided they are used under the terms and conditions spelled out in our warranty clause of our contract.